

DIMENSIONE D'INGOMBRO / Overall dimensions  
 POMPE PER VUOTO AD ANELLO DI LIQUIDO

Liquid ring vacuum pumps

SERIE / Series

**TRHE serie 32 / C**

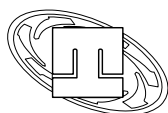

**pompetravaini** S.p.A.

CASTANO PRIMO (MILANO)

Versione **ACCOPIATA (BASE-GIUNTO)**  
**COUPLED construction (BASEPLATE-COUPLING)**

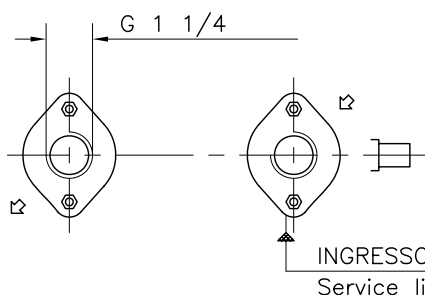
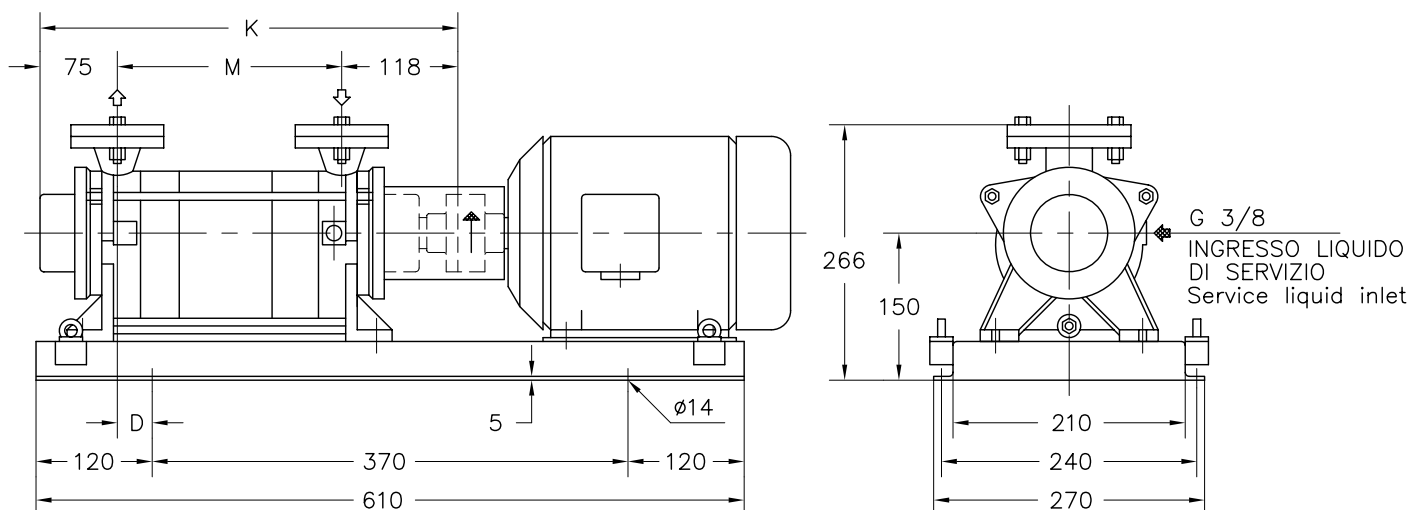

CONTROFLANGE FILETTATE  
 FLANGE SECONDO UNI 2224 PN 6  
 Threaded companion flanges  
 Flanges according to UNI 2224 NP 6

| POMPA TIPO<br>Pump type | MOTORE A 2 POLI<br>2 Poles Motor<br>UNEL-MEC-B3 |     | BASE<br>Base-plate<br>N° | POMPA<br>Pump |     |     | PESO<br>Weight<br>① |
|-------------------------|---|-----|--------------------------|---------------|-----|-----|---------------------|
|                         | TIPO/Type                                       | KW  |                          | D             | K   | M   |                     |
| TRHE 32-20              | 80 B  | 1,1 | 902                      | 47            | 332 | 139 | 34                  |
|                         | 90 S  | 1,5 |                          |               |     |     |                     |
| TRHE 32-45              | 90 L  | 2,2 |                          | 77            | 382 | 189 | 37                  |

① PESO ESCLUSO MOTORE  
 Weight without motor

DISEGNO SCHEMATICO - DIMENSIONI IN MM. CON TOLLERANZE SECONDO EN 735-1995 E PESI IN KG. NON IMPEGNATIVI  
 Schematic drawing - Dimensions in mm. with tolerances according to EN 735-1995 and weights in kgs. not binding